



Dowsett Road, N17 9DD

£1,630 per month | 2 Bedroom Flat





Dowsett Road, N17 9DD

£1,630 per month | 2 Bedroom Flat

A brand-new luxury 2 bedroom flat located on the ground floor with private garden. This exceptional home is offered with a contemporary interior and features an open plan integrated kitchen with all appliances and granite worktops. Living room with sleek wood floors and space to dine leading to the garden with patio and seating area.

There are two ample bedrooms with fitted storage , low voltage lighting, double glazing and gas central heating.

Dowsett Road has a central location being just moments from Tottenham High Road with its range of independent shops , supermarkets and restaurants. The area is well served by extensive local transport with Bruce Grove rail station and bus routes just a short walk away. The tube and rail stations of Seven Sisters and Tottenham Hale with the retail park are also close to hand.

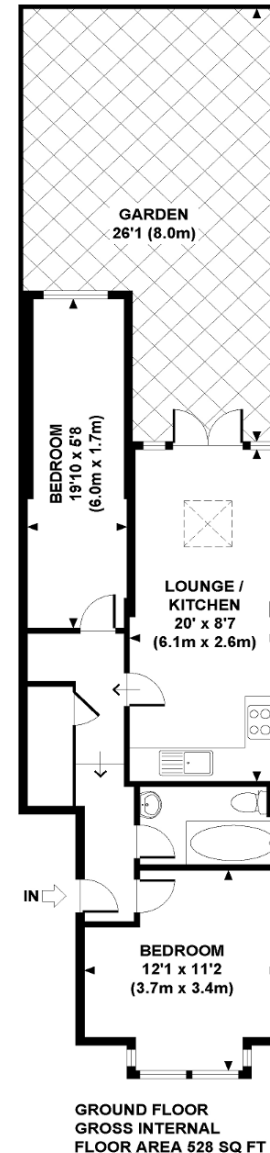



Tenant Terms & Fees

Tenancy fees and terms for tenants - Short Lets:

- A minimum of a four weeks deposit must be paid in advance for all short let rentals that exceed 60 days duration.
- For short let rentals all moving in monies have to be paid in advance for the duration of the tenancy.
- Long/Short Let Rentals - Mid tenancy to end of tenancy
- Tenant/Occupant change Fee £50 per person
- Deposit- where our client landlord is not a member of any insurance based or custodial scheme, such monies will be held Ashmore Estates Limited as stakeholder in an insurance based scheme TDS (Tenancy deposit scheme).

Tenancy fees and terms for tenants - Long Lets:

Should you wish to terminate your tenancy before the end of the fixed term and the landlord agrees that you can terminate early, you will be responsible for the repayment of the pro-rata commission paid in advance by the landlord for the unexpired portion of the tenancy, unless you are exercising a break clause which is contained in your tenancy agreement.

It is your obligation to obtain written consent from the landlord for any change in the identity of the tenants. Upon receipt of this consent Ashmore Residential will draw up a tenancy agreement for signature by all parties.

An administration fee of £25 will be charged for each letter sent by Ashmore Residential regarding late or non-payment of rent or administration charges.

Long/Short Let Rentals - Mid tenancy to end of tenancy.

Tenant/Occupant change Fee £50 per person

Deposit- where our client landlord is not a member of any insurance based or custodial scheme, such monies will be held Ashmore Estates Limited as stakeholder in an insurance based scheme TDS (Tenancy deposit scheme).

